

Quick Setup Guide

Please read the manual before using Ferrum Power Splitter!

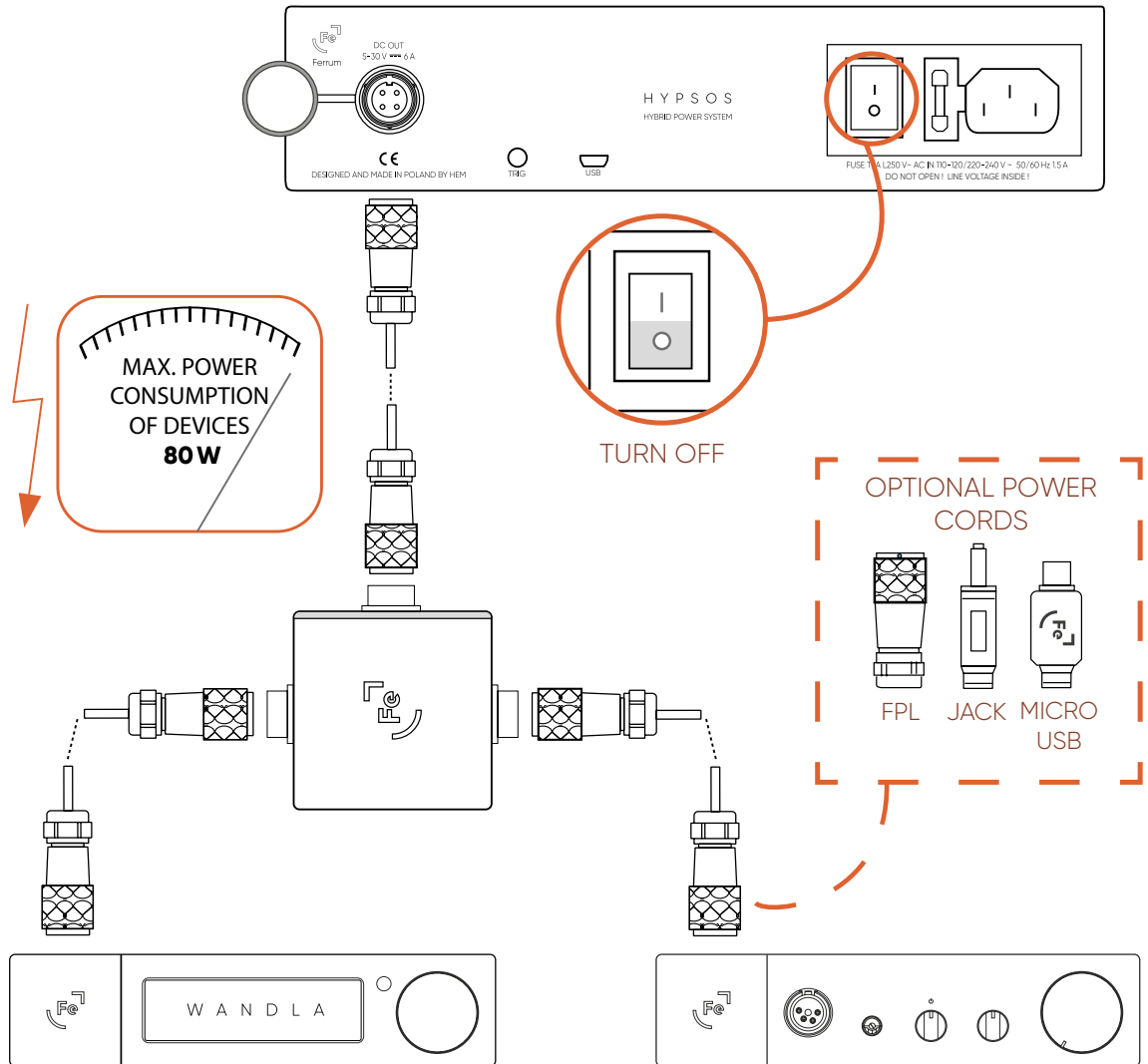

CONNECT
FPS WITH
HYPSOS
AND
EXTERNAL
DEVICES



Set correct voltage values on HYPSOS before connecting Ferrum Power Splitter with external devices

For the full manual please visit: ferrum.audio/support or scan the QR code.



<p>Choose the Device</p> <p>If you do not find your device on the list, please choose manual configuration.</p>	<p>USB powered device</p> <p>Manual Configuration</p>	<p>Set Voltage</p> <p>Set voltage accordingly to the device's specification.</p> <p>18.0 V</p> <p>5V 30V</p>
<p>Set Polarity</p> <p>Set polarity accordingly to the device's specification.</p> <p>Center Negative</p> <p>Center Positive</p>	<p>Apply Parameters</p> <p>Attention: Wrong voltage level and polarity may destroy your device!</p> <p>Polarity: \ominus \oplus</p> <p>Voltage: 18.0 V</p> <p><input type="checkbox"/> <input checked="" type="checkbox"/></p>	

Warranty

Each individual Ferrum Power Splitter undergoes comprehensive quality control and a complete test before shipping.

If you suspect that your product is faulty, please contact the place of purchase or you contact Ferrum support. Prior to shipping for warranty services the customer or dealer must obtain an RMA number from Ferrum for warranty services. Units sent without an RMA number will not be accepted.

Proof of purchase in the form of a bill of sale or received invoice, which is evidence that this product is within the warranty period, must be presented to obtain warranty service. This warranty is void and inapplicable if the factory applied Serial Number has been altered or defaced from this product. Faults due to customer misuse, unauthorized modifications or accidents are not covered by this warranty.

Please pack the product very carefully, preferable in the original packing, to be sure no damage can be done during shipment.

Information on Disposal for Users of Waste Electrical & Electronic Equipment (private households).

The Wheelie Bin symbol on the products and/or accompanying documents means that used electrical and electronic products should not be mixed with general household waste. Disposing of this product correctly will help save valuable resources and prevent any potential negative effects on human health and the environment. To properly dispose harmful substances and recycle the product, the user is obliged to return it at the point of collection of electrical and electronic equipment waste. For more information please contact your local authorities, waste disposal units or retailer.



CHECK VOLTAGE AND POLARITY

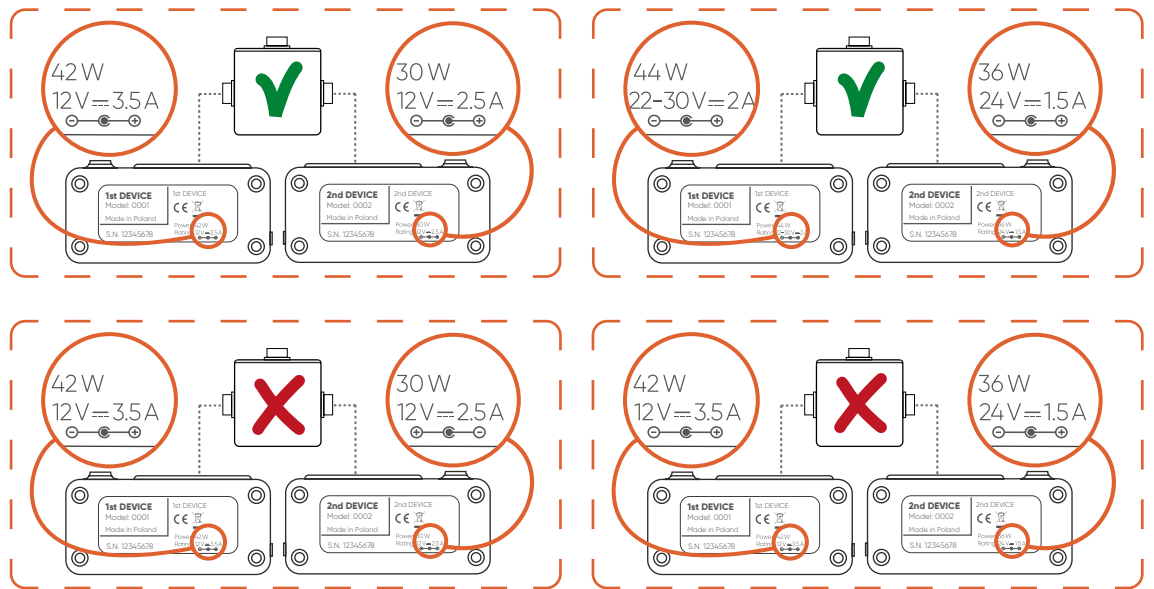

Do you want to be up to date with the Ferrum brand? Go to our webpage and subscribe to the newsletter.

<https://ferrum.audio>

Thank you for choosing Ferrum Power Splitter.

We at **Ferrum** listen to our customers and when some of them told us they would like to power more than one device with their **HYPSONS**, we immediately sat down and discussed this question with our engineers. To make this possible our engineers designed the Ferrum Power Splitter (FPS).

Now you can power two devices of your choice with just one **HYPSONS**